

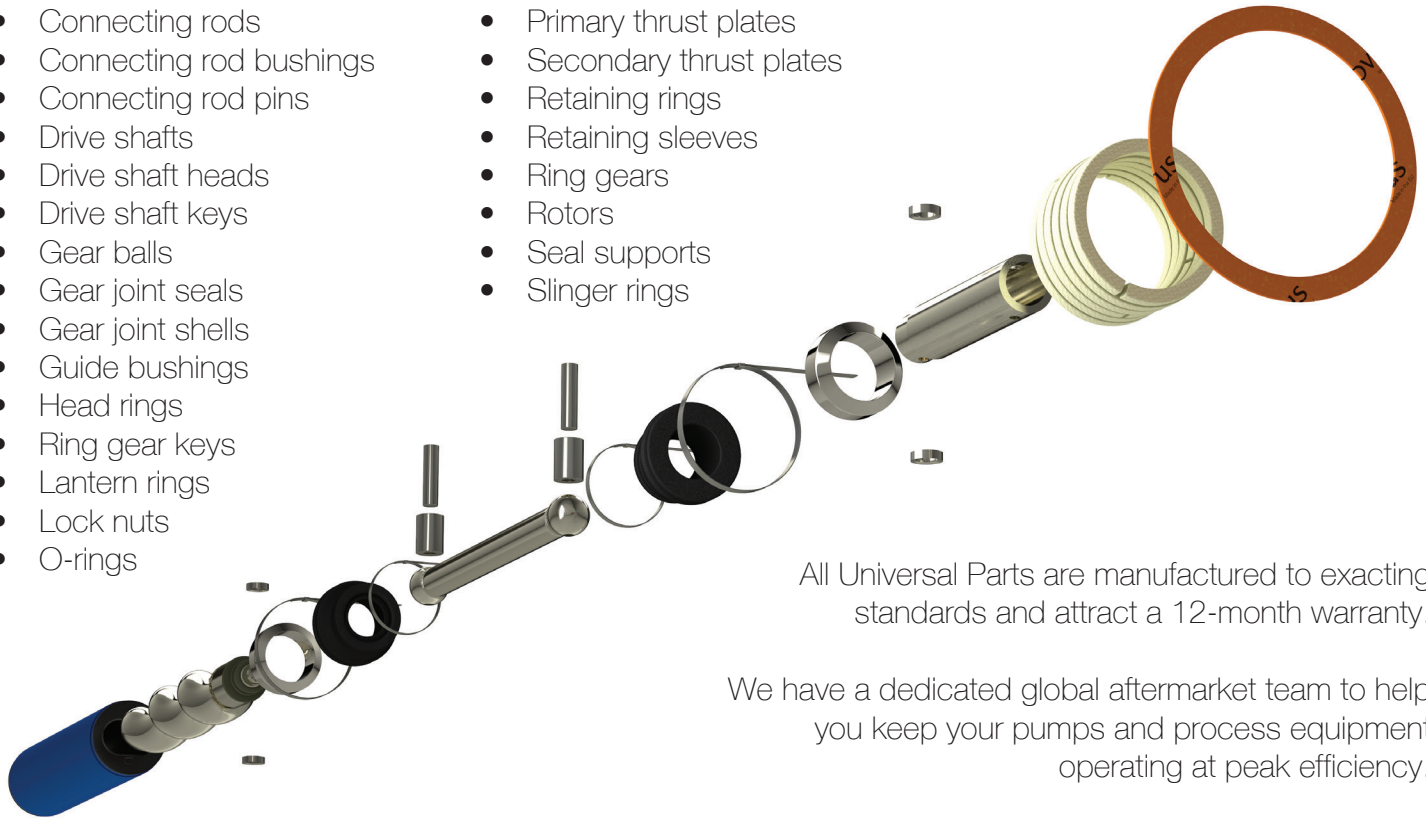

Quality
Reliability
Availability

We are the world's largest manufacturer of progressing cavity pumps. So it's not surprising that we also provide over 3 million high quality parts that fit into other brands of progressing cavity pumps. On selected models, we offer our customers the fully assembled rotating units or individual parts including:

- Boots
- Casing gaskets
- Connecting rods
- Connecting rod bushings
- Connecting rod pins
- Drive shafts
- Drive shaft heads
- Drive shaft keys
- Gear balls
- Gear joint seals
- Gear joint shells
- Guide bushings
- Head rings
- Ring gear keys
- Lantern rings
- Lock nuts
- O-rings
- Packing
- Plug-in shafts
- Primary thrust plates
- Secondary thrust plates
- Retaining rings
- Retaining sleeves
- Ring gears
- Rotors
- Seal supports
- Slinger rings
- Small & large holding bands
- Stators



All Universal Parts are manufactured to exacting standards and attract a 12-month warranty.

We have a dedicated global aftermarket team to help you keep your pumps and process equipment operating at peak efficiency.

	seepex™	NETZSCH™	PCM™	ALLWEILER™	R & M™	Bornemann™	ORBIT™
PUMP RANGES	BN NS BT MD	NEMO™ NM™ NE™ NU	I and ID IVA and IDVA MR/MV-I and ID	TECFLOW™ AE SN SH SZ	Century VIII Century III (TL) Century III (TM) Century III (TP) Century IX Century V (T) Century IV (TJ) Century VI (TFG & TFF) Century I (TWG)	E Range	C Range A and B Range D and E Range
GEOMETRY	Std (standard) L (long pitch) T (2/3)	S (standard) L (long pitch) P (2/3 long)		Std (standard) TECFLOW™ (2/3)			

Third party trademarks, trade names, and models above are only used as reference to indicate compatible replacement parts. The trademarks, trade names, and models are the property of their respective owners* and their use implies no affiliation with, nor endorsed by NOV. All products advertised herein are solely manufactured by NOV or its associated and affiliated entities. *SEEPEX is a trademark of Seepex GMBH, NETZSCH, NEMO, NM, NE, AND NU are trademarks of NETZSCH - Mohnpumpen GmbH, PCM is a trademark of PCM, ALLWEILER AND TECFLOW are trademarks of Allweiler GmbH, ROBBINS & MYERS is a trade mark of Robbins & Myers, Inc., BORNEMANN is a trademark of Joh. Heinn. Bornemann GmbH, and ORBIT is a trademark of Denorco (Pty) Ltd.

Distributed by:



“Fluid Handling Specialists”

D.J. Shubeck Company

3111 Stage Post Dr., Suite 101; Bartlett, TN 38133

Phone: 901-372-2400 Fax: 901-372-4777

Email: steveschneider@djshubeck.com

www.bigonUP

